

NSU 11 S/D/F

Dispenser for liquid soaps (S), disinfectants (D)
and foam soaps (F), stainless steel (AFP) or powder-coated, 1200 ml

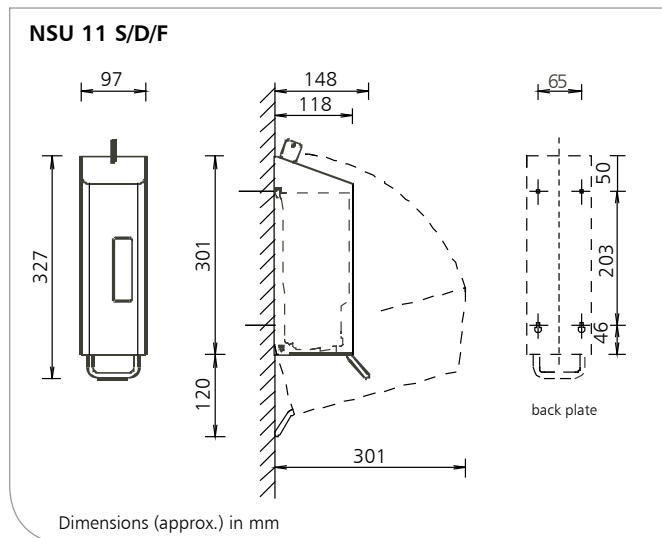

Product characteristics

- Dispenser for dosing liquid soaps and disinfectants (S), low-viscosity hand disinfectants with spray pump (D) or foam soap (F)
- Refillable soap dispenser with 1200 ml volume plus overfill quantity
- Housing with sloping lid to prevent foreign objects being placed on the dispenser
- High-quality and robust stainless steel housing
- Hygienic and easy-to-clean stainless steel operating lever
- Plastic lock with anti-vandalism function
- Press-actuation protects the wall attachment
- Modular system with replaceable container/pump unit, for liquid soaps and disinfectants (S), low-viscosity hand disinfectants with spray pump (D) or foam soap (F)
- Dispensing quantity ca. 0.7 ml/stroke (D spray pump), ca. 0.7 ml/stroke (F foam pump), ca. 1.5 ml/stroke (S lotion pump)
- Easily filled from above
- Open without wall contact
- Container easily removed for cleaning
- Viewing window to check fill level
- Incl. mounting kit for four-point wall mounting

Interesting information

References: ► Conference centres, exhibitions, airports, train stations, catering, retirement/care homes, hospitals, laboratories, commercial kitchen, food processing, industry, shopping centres, hotels, correctional facilities, schools, kindergartens, sports centres, administration facilities

Application examples:

- Washrooms, toilets, baths, care and examination rooms, kitchens, production facilities, entrance areas

Technical data

Housing:	Stainless steel AISI 304, brushed with Anti-Fingerprint Coating (AFP) or powder-coated white (RAL 9010)
Operating lever:	Stainless steel AISI 304
Viewing window:	Transparent plastic
Dosing pump:	For liquid soaps and disinfectants (S), low-viscosity hand disinfectants with spray pump (D) or foam soap (F), dispensing quantity ca. 0.7 (D) – 0.7 (F) – 1.5 (S) ml/stroke
Lock:	Anti-vandalism lock, plastic
Wall mounting:	Wall mounting with 4 screws and wall plugs

Description for tender - see overleaf

NSU 11 S/D/F/0618/1.2



Subject to technical modifications.
Tests are required before new filling materials are used!

OPHARDT
hygiene

OPHARDT Hygiene-Technik GmbH + Co. KG
Lindenau 27 | 47661 Issum | Germany
Tel.: +49 2835 18-10 | Fax: +49 2835 18-77
www.ophardt.com | E-Mail: planer@ophardt.com

NSU 11 S/D/F

Dispenser for liquid soaps (S), disinfectants (D)
and foam soaps (F), stainless steel (AFP) or powder-coated, 1200 ml

Description for tender

... Pcs. **SanTRAL® NSU 11 E/S Art. No. 1415817** Pcs.
Dispenser for disinfectant and liquid soaps,
1200 ml, brushed stainless steel housing with
Ophardt hygiene Anti-Fingerprint Coating
(AFP), stainless steel back plate, stainless steel
operating lever, press-actuation, special lock
with anti-vandalism function, viewing window
for monitoring filling level, removable refillable
container, free choice of manufacturers for refill
materials,
Housing with sloping lid to prevent foreign
objects being placed on the dispenser
Dimensions (W x H x D) 97 x 327 x 148 mm

... Pcs. **SanTRAL® NSU 11 P/S Art. No. 1415818** Pcs.
Dispenser for disinfectant and liquid soaps,
1200 ml,
**White (RAL 9010) powder-coated stainless
steel housing**, stainless steel back plate, stainless
steel operating lever, press-actuation, special lock
with anti-vandalism function, viewing window
for monitoring filling level, removable refillable
container, free choice of manufacturers for refill
materials,
Housing with sloping lid to prevent foreign
objects being placed on the dispenser
Dimensions (W x H x D) 97 x 327 x 148 mm

... Pcs. **SanTRAL® NSU 11 E/D Art. No. 1415819**
Dispenser for disinfectant, 1200 ml,
**brushed stainless steel housing with
Ophardt hygiene Anti-Fingerprint Coating
(AFP)**, stainless steel back plate, stainless steel
operating lever, press-actuation, special lock
with anti-vandalism function, viewing window
for monitoring filling level, removable refillable
container, free choice of manufacturers for refill
materials,
Housing with sloping lid to prevent foreign
objects being placed on the dispenser
Dimensions (W x H x D) 97 x 327 x 148 mm

... Pcs. **SanTRAL® NSU 11 P/D Art. No. 1415820**
Dispenser for disinfectant, 1200 ml,
**White (RAL 9010) powder-coated stainless
steel housing**, stainless steel back plate, stainless
steel operating lever, press-actuation, special lock
with anti-vandalism function, viewing window
for monitoring filling level, removable refillable
container, free choice of manufacturers for refill
materials,
Housing with sloping lid to prevent foreign
objects being placed on the dispenser
Dimensions (W x H x D) 97 x 327 x 148 mm

SanTRAL® NSU 11 E/F Art. No. 1415312
Dispenser for foam soaps, 1200 ml,
**brushed stainless steel housing with
Ophardt hygiene Anti-Fingerprint Coating
(AFP)**, stainless steel back plate, stainless steel
operating lever, press-actuation, special lock
with anti-vandalism function, viewing window
for monitoring filling level, removable refillable
container, free choice of manufacturers for refill
materials,
Housing with sloping lid to prevent foreign
objects being placed on the dispenser
Dimensions (W x H x D) 97 x 327 x 148 mm

SanTRAL® NSU 11 P/F Art. No. 1415413
Dispenser for foam soaps, 1200 ml,
**White (RAL 9010) powder-coated stainless
steel housing**, stainless steel back plate, stainless
steel operating lever, press-actuation, special lock
with anti-vandalism function, viewing window
for monitoring filling level, removable refillable
container, free choice of manufacturers for refill
materials,
Housing with sloping lid to prevent foreign
objects being placed on the dispenser
Dimensions (W x H x D) 97 x 327 x 148 mm

Product: **SanTRAL®**
Manufacturer: OPHARDT HYGIENE-TECHNIK GmbH + Co. KG

Compatible accessories

- Stainless steel drip tray for mounting with the
dispenser (preset distance from the bottom edge)
Art. No. 1420578
Dimensions (W x H x D) 95 x 186 x 128.3mm
- Stainless steel drip tray for mounting under the
dispenser (distance from the bottom edge can be
freely selected, additional mounting holes)
Art. No. 1420577
Dimensions (W x H x D) 97 x 328 x 146 mm